

- NOTES:
- MATERIAL:
    - HOUSING: THERMOPLASTIC, HIGH TEMP., UL94V-0.
    - CONTACT: COPPER ALLOY.
  - FINISH:
    - CONTACT:
      - 50u" MIN. NICKEL UNDERPLATING OVERALL.
      - GOLD FLASH OVERALL.
      - N: 120u" MIN. Pure Tin(MATT TIN) OVER ALL.
  - SPEC. PLS. REFER TO PS-50647-xxxx-xxx.
  - PACKAGE PLS. REFER TO 88200-TB.
  - PART NUMBER.

P/N LEGEND  
50649-XXX X X-XXX

|     |              |                |
|-----|--------------|----------------|
| XXX | Housing MAT. | Housing Color. |
| 001 | HF PLASTIC   | BLACK          |

NO OF CONTACT ——— X  
PACKING ——— X  
1:TUBE

PLATING  
N:MATT TIN(LEAD FREE)  
1:G/F OVER ALL(LEAD FREE)

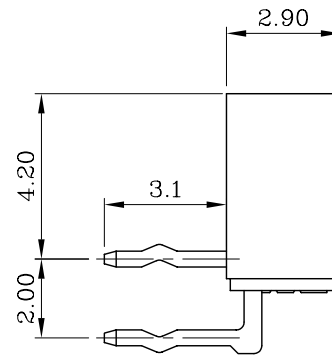
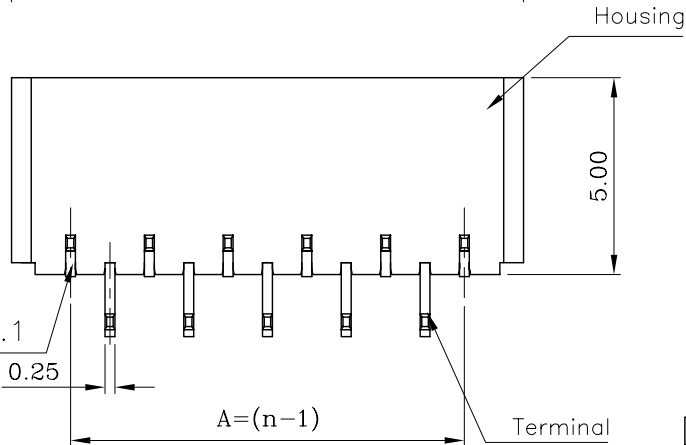
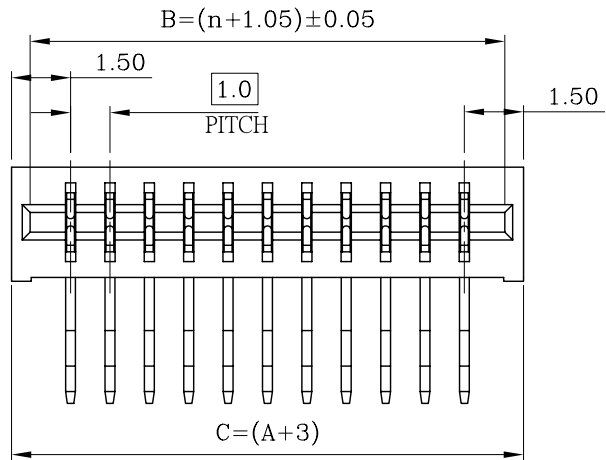

| CKT | DIM A | DIM B | DIM C | CKT | DIM A | DIM B | DIM C |
|-----|-------|-------|-------|-----|-------|-------|-------|
| 3   | 2.0   | 4.1   | 5.0   | 15  | 14.0  | 16.1  | 17.0  |
| 4   | 3.0   | 5.1   | 6.0   | 16  | 15.0  | 17.1  | 18.0  |
| 5   | 4.0   | 6.1   | 7.0   | 17  | 16.0  | 18.1  | 19.0  |
| 6   | 5.0   | 7.1   | 8.0   | 18  | 17.0  | 19.1  | 20.0  |
| 7   | 6.0   | 8.1   | 9.0   | 19  | 18.0  | 20.1  | 21.0  |
| 8   | 7.0   | 9.1   | 10.0  | 20  | 19.0  | 21.1  | 22.0  |
| 9   | 8.0   | 10.1  | 11.0  | 21  | 20.0  | 22.1  | 23.0  |
| 10  | 9.0   | 11.1  | 12.0  | 22  | 21.0  | 23.1  | 24.0  |
| 11  | 10.0  | 12.1  | 13.0  | 23  | 22.0  | 24.1  | 25.0  |
| 12  | 11.0  | 13.1  | 14.0  | 24  | 23.0  | 25.1  | 26.0  |
| 13  | 12.0  | 14.1  | 15.0  | 25  | 24.0  | 26.1  | 27.0  |
| 14  | 13.0  | 15.1  | 16.0  | 26  | 25.0  | 27.1  | 28.0  |

|     |                      |          |            |
|-----|----------------------|----------|------------|
| 0   | 新圖製成                 | 08/10/20 | wuweiliang |
| REV | 修改摘要                 | 日期       | 簽名         |
|     | REVISION DESCRIPTION | DATE     | SIGNATURE  |

|   |  |  |  |
|---|--|--|--|
| 一般公差<br><b>TOLERANCES</b><br>X ±0.5 XX ±0.15<br>X ±0.25 XXX ±0.1<br>ANGLES ±2°                                    |  | 宏致電子股份有限公司<br>Aces Electronic Co.,Ltd.   |  |
| 檢驗尺寸標示<br><b>SYMBOLS</b> ⊕ ⊗ INDICATE CLASSIFICATION DIMENSION<br>⊕ MARK IS CRITICAL DIM.<br>⊗ MARK IS MAJOR DIM. |  | 品名 (TITLE)<br>1.0mm NON ZIF FPC CONN. T/H R/A TYPE<br>圖號 (DWG.NO)<br>50649-XXXXX-XXX |  |
| 表面處理 (FINISH)   |  | 比例 (SCALE) 單位 (UNITS) 1:1 mm   |  |
| 製圖 (DR) weiliang<br>08/10/14<br>審核 (CHKD) wgch<br>核准 (APPD) JASON   |  | 張數 (SHEET) 1 OF 1<br>SIZE A4<br>REV 0  |  |